

ADDENDUM NO. 2

Date of Issue: **OCTOBER 24, 2023**

Project: **ROOF REPLACEMENT FOR VALLEY REGIONAL FIRE AND RESCUE**

Project Owner: **VALLEY REGIONAL FIRE AND RESCUE**
14 West Butler Drive, Drums, PA 18222

Bid Due Date: **NOVEMBER 7, 2023 AT 12:00 PM** (Noon - Local Prevailing Time)
At the office of Levkolic Associates, 101 East Union Street, Pottsville, PA 17901

The following changes, additions, revisions and/or clarifications are hereby incorporated into and shall become part of the contract documents and are issued to amend or clarify the drawings or specifications. Any items not mentioned herein nor affected hereby shall be performed in strict accordance with the original specifications and drawings. Failure of any bidder to acknowledge receipt of this Addendum in the space provided in his Proposal, may be sufficient cause for rejection of his Proposal.

Prior to submission of a bid for this project, all Contractors are urged to visit the Levkolic Associates website at www.levkolicgroup.com to view the most current information pertaining to this project.

I. GENERAL CLARIFICATIONS:

- A. As a clarification, due to the existing roof deck being concrete, a vapor barrier shall be provided. Vapor barrier shall be installed per manufacturer's requirements for the specified warranty.
- B. An RFI was received from Budget Roofing
 - Q1: On the blueprints, it shows the drains at 3.5 inches but on reroofing notes, it says 1 ½ inches on drains. Please clarify.
 - A1: Insulation thickness at the drains shall be 3.5" minimum. The average R-Value for a 4-way slope is R-40. The average R-Value for a 2-way slope with crickets is R-36. Should the Owner choose to award the bid alternate, 4-way slope will be required.

END OF ADDENDUM

LA Project No. 22-027

ADDENDUM NO. 1

Date of Issue: **OCTOBER 19, 2023**

Project: **ROOF REPLACEMENT FOR VALLEY REGIONAL FIRE AND RESCUE**

Project Owner: **VALLEY REGIONAL FIRE AND RESCUE**
14 West Butler Drive, Drums, PA 18222

Bid Due Date: **NOVEMBER 7, 2023 AT 12:00 PM** (Noon - Local Prevailing Time)
At the office of Levkolic Associates, 101 East Union Street, Pottsville, PA 17901

The following changes, additions, revisions and/or clarifications are hereby incorporated into and shall become part of the contract documents and are issued to amend or clarify the drawings or specifications. Any items not mentioned herein nor affected hereby shall be performed in strict accordance with the original specifications and drawings. Failure of any bidder to acknowledge receipt of this Addendum in the space provided in his Proposal, may be sufficient cause for rejection of his Proposal.

Prior to submission of a bid for this project, all Contractors are urged to visit the Levkolic Associates website at www.levkolicgroup.com to view the most current information pertaining to this project.

I. GENERAL CLARIFICATIONS:

- A. As a clarification, prevailing wage rates shall not be applicable to this project. Any references to prevailing wage rates shall be deleted. Similarly for the requirement of submitting Certified Payrolls.
- B. As a clarification, core samples show the existing roof deck to be concrete. Due to this, entire system shall be adhered. Contractor shall perform a peel test to verify adherence with substrate for wind uplift requirements.
- C. Project drawings for Bid Alternate indicate a new door to be cut into the existing building and a new ramp to be installed within the building. This work shall be deleted. All other items pertaining to Bid Alternate shall be provided within the Alternate Price.
- D. As a clarification, Proposed Roof Section 3/G3/G3 on Drawing Sheet G3 notation was cut off and did not appear as intended. Please refer to the attached SK1 drawing reissuing the section as intended.
- E. Roof cores conducted on site indicated a roof system thickness of approximately 4" – 6" to the concrete deck.
- F. As a clarification pertaining to job completion and schedule, the successful Contractor will be required to meet with the Owner to develop a mutually agreeable schedule / project duration, that takes into account receipt of materials and weather conditions that will impact project delivery. A Contract will be subsequently developed that incorporates the factors listed above to reflect the contract completion date.

END OF ADDENDUM
LA Project No. 22-027

VALLEY REGIONAL FIRE AND RESCUE ROOF REPLACEMENT 14 WEST BUTLER DRIVE DRUMS, PA 18222

DO NOT SCALE DRAWINGS. DRAWINGS ARE NOT NECESSARILY TO SCALE.

SCALE AS NOTED	DRAWN BY TFW	DRAWING NO. SK-1
DATE 10/19/2023	CHECKED BY JEL	
PROJECT NO. 22-027	DWG FILE 22-027	

LEVKULIC ASSOCIATES

design · management · consulting

union street station
101 east union street
pottsville, pennsylvania 17901

phone: 570.628.2887

www.levkulicgroup.com

ADDENDUM NO. 1 - DETAIL 3/G3/G3 REISSUE

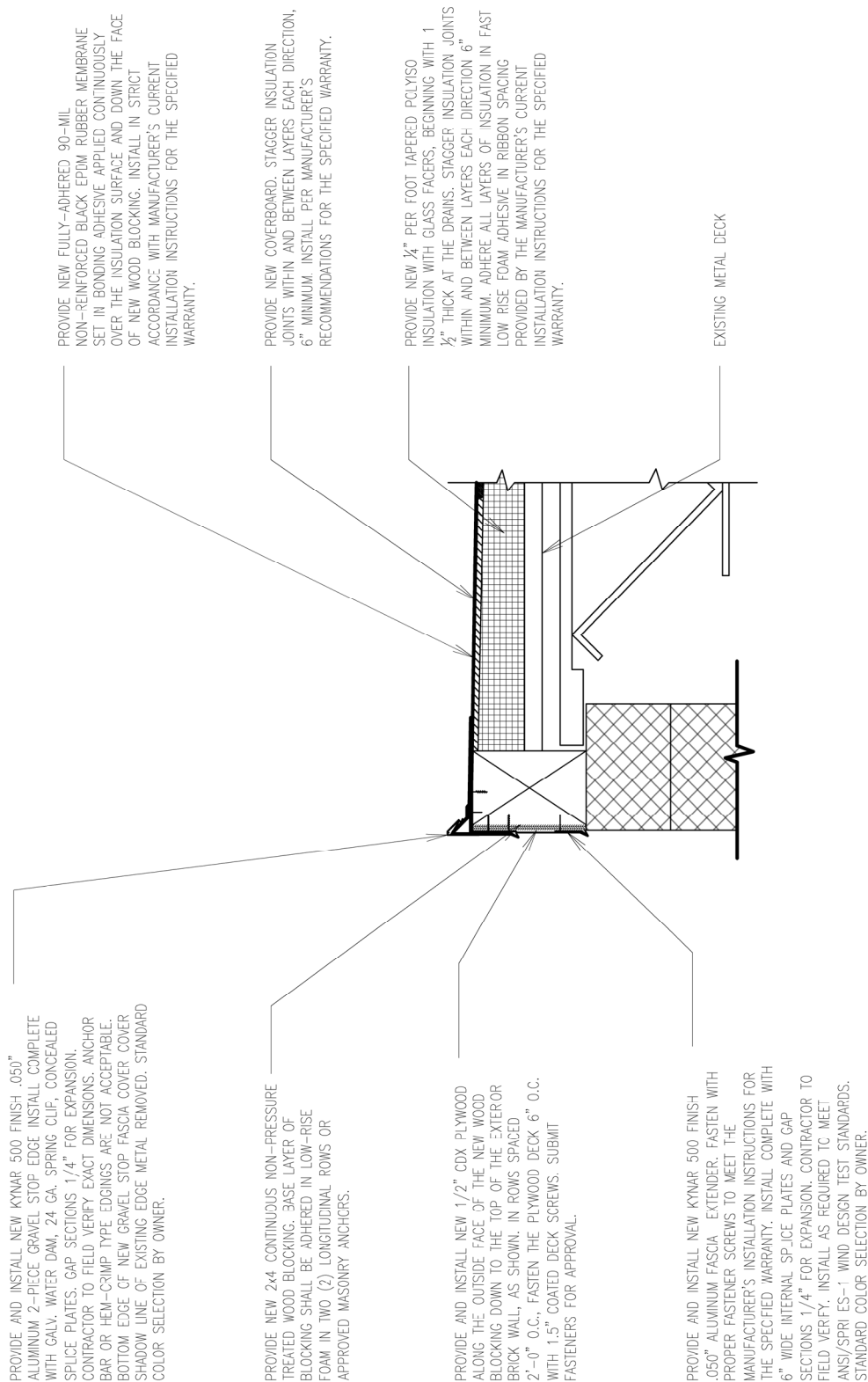

ALL DRAWINGS AND WRITTEN MATERIALS APPEARING HEREIN CONSTITUTE ORIGINAL AND UNPUBLISHED WORK OF LEVKULIC ASSOCIATES. NO PART OF THIS DRAWING SHALL BE REPRODUCED, COPIED, OR REVISED FOR THE PURPOSE OF COPYING THIS WORK, OR REVISING SAID DRAWING SHALL, IN NO CIRCUMSTANCE, BE APPROVED. VIOLATION OF THIS RESTRICTION SHALL BE CONSIDERED A VIOLATION OF THE PROFESSIONAL CONTRACT AND SHALL BE SUBJECT TO THE COMPANY'S POLICY OF WHICH SHALL BE PROSECUTED TO THE FULLEST EXTENT OF CURRENT STATUTES.

DO NOT SCALE DRAWINGS. DRAWINGS ARE NOT NECESSARILY TO SCALE. DIMENSIONS SHOWN ON DRAWINGS SHALL TAKE PRECEDENCE OVER DIMENSIONS FOR INTERPRETATION OR CLARIFICATION. ALL DIMENSIONS AND EXISTING CONDITIONS SHALL BE CHECKED AND VERIFIED BY THE CONTRACTOR AT THE PROJECT SITE.